

Hockey Puck Elements

5 - 425 m³/hr Flow Range

Features

- High grade filter element
- Element construction of injection molded thermoplastic
- Integrated gasket seal
 - Positive seal between housing hemispheres
 - New seal with each element
 - Minimizes parts
- Optimal surface area per given size
- Pleated media for high dirt holding capacity

Technical Specifications

- Temp (continuous): min -26°C (-15°F) max 104°C (220°F)
- Filter change out differential: 37-50 mbar over initial ΔP
- Polyester: 99%+ removal efficiency standard to 10 micron
- Paper: 99%+ removal efficiency standard to 2 micron



Polyester Media Benefits/Specs

- Less maintenance due to longer durability
- Moisture resistant
- Handles hot air and oil mist from unload cycle of reciprocating/piston compressor
- Washable with lukewarm water and mild detergent (replacing element is recommended)

Paper Media Benefits/Specs

- Heavy duty industrial strength paper
- Cost effective
- Gently blow out media (replacing element is recommended)

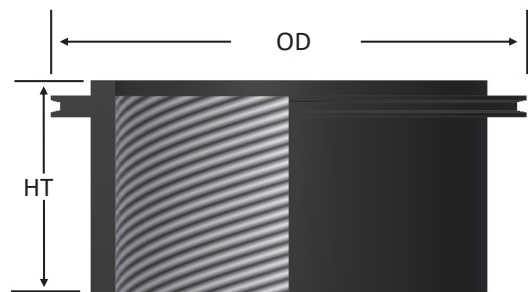

Element Part Number		Dimensions - mm		Surface Area m ²	Element m ³ /hr Rating
Polyester	Paper	O.D.	H.T.		
03	02	38	25	0.009	5
05	04	57	25	0.019	14
07	06	76	35	0.054	20
11	10	102	35	0.10	60
17*	16	191	83	0.74	425

*Minimum order quantity applies.

See Element Technical Data for maintenance guidelines. Contact factory for options.

Rev: HockeyPuck EU1907N

United Kingdom
Phone: +44 (0) 1902 798499
UKsales@solbergmfg.com

Belgium
Phone: +32 3 774 52 11
BEsales@solbergmfg.com

Germany
Phone: +49 9129 145 3902
vertrieb@solbergmfg.com

Slovakia
Phone: +421 (0) 48 41 33 251
predaj@solbergmfg.com

All model offerings and design parameters are subject to change without prior notice.
Contact your representative or Solberg for the most current information.

www.solbergmfg.com