

REV	DESCRIPTION	ECN #	CHG BY	DATE	APP'D
A	UPDATED TO STANDARD LAYOUT	21382	TAS	03/03/21	NAD

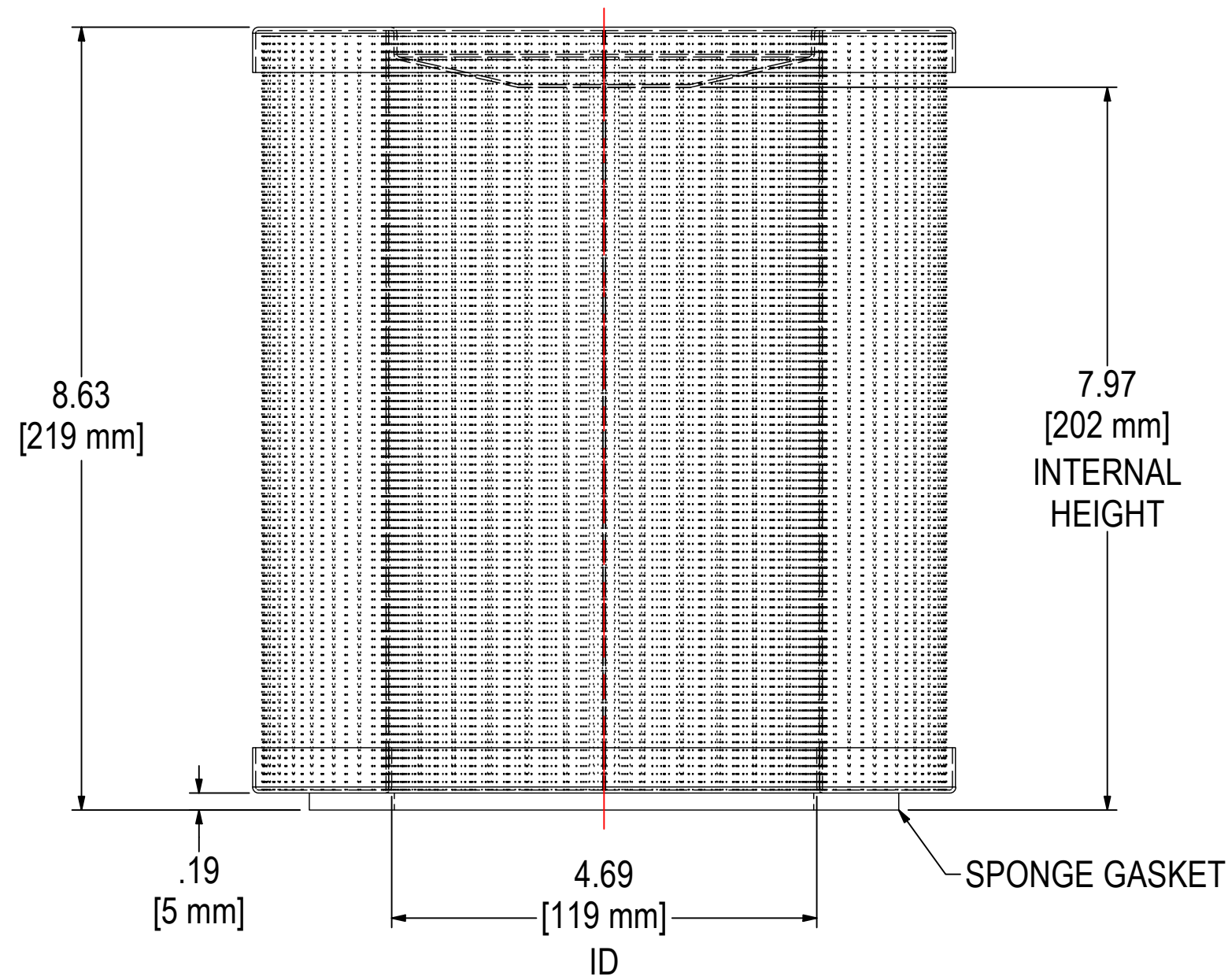
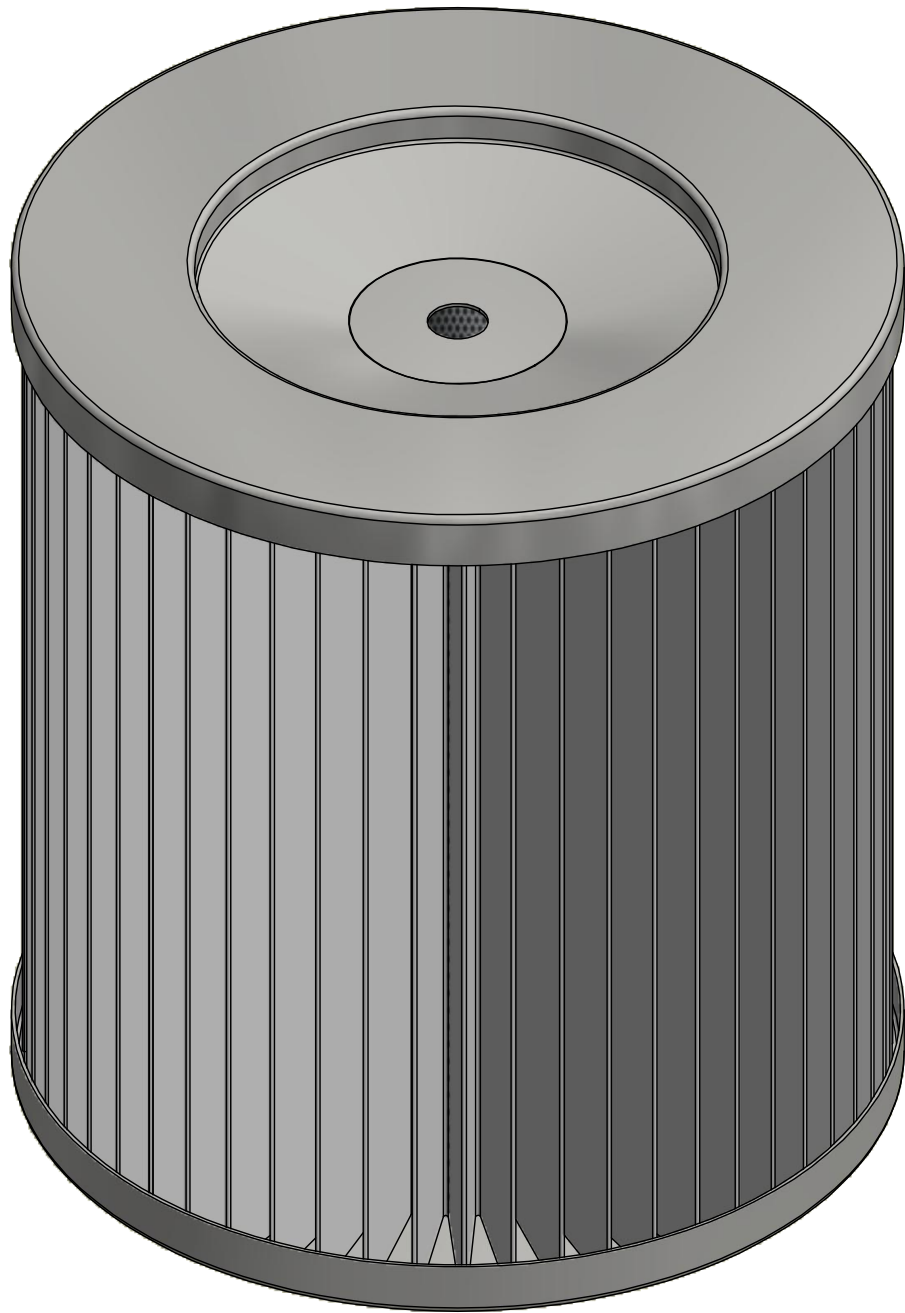
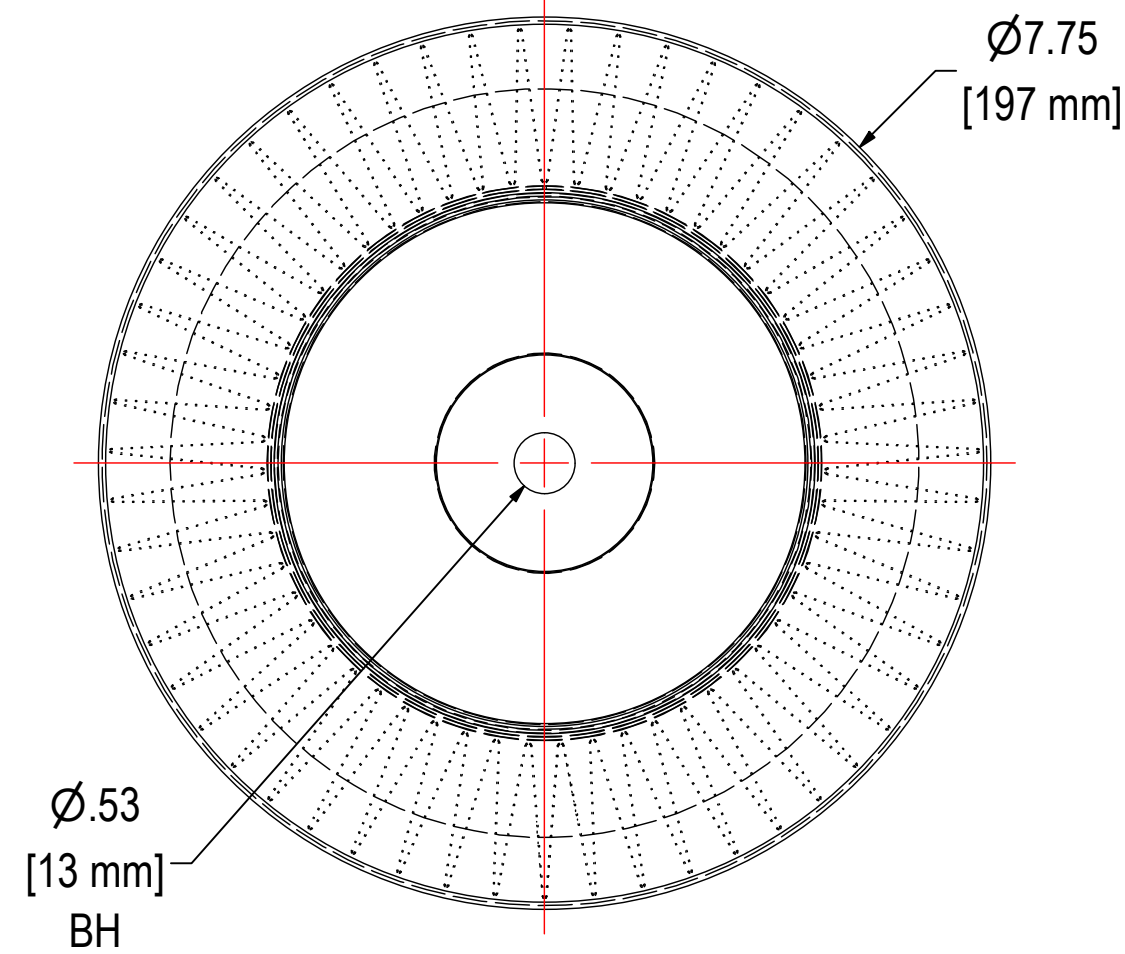

ELEMENT SPECS		
PART NUMBER	237	
MATERIAL	POLYESTER	
FLOW RATE	550 CFM	934 m ³ /hr
SURFACE AREA	8.0 ft ²	0.7 m ²
I.D.	4.69"	119mm
O.D.	7.75"	197mm
HEIGHT	8.63"	219mm