

REV	DESCRIPTION	ECN #	CHG BY	DATE	APP'D
A	CONVERTED TO 3D	28014	CJM	11/13/23	EZR

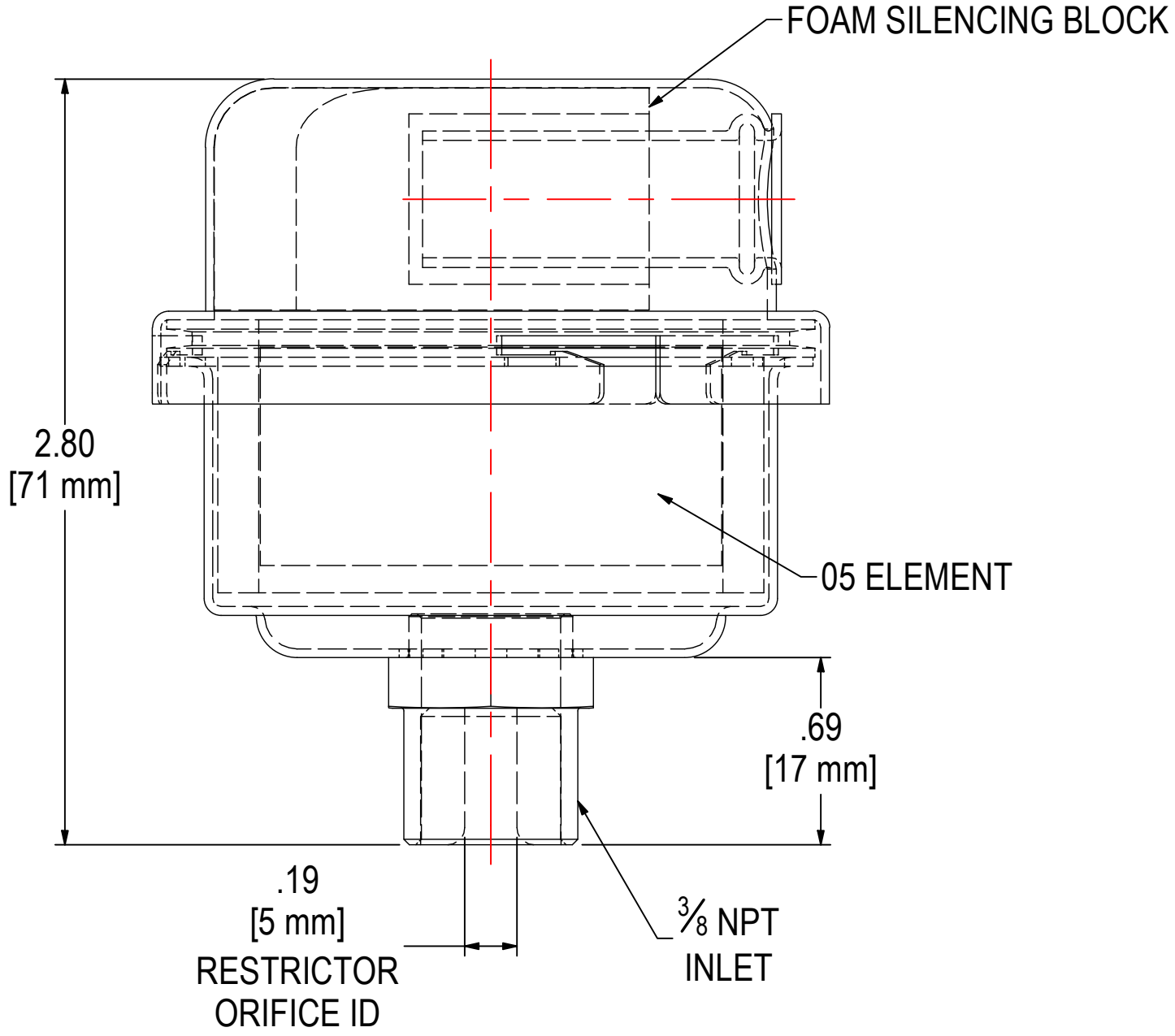

ELEMENT SPECS		
PART NUMBER	05	
MATERIAL	POLYESTER	
FLOW RATE	8 CFM	13 m³/hr
SURFACE AREA	0.2 ft²	0.0 m²
I.D.	N/A	N/A
O.D.	2.38"	60mm
HEIGHT	1.00"	25mm

MODEL #: EFS-05-038/1		MATERIAL: CARBON STEEL		FINISH: BLACK POWDER	
MODEL NUMBER: EFS-05-038/1					SHEET: 1 OF 1
DESCRIPTION: EFS-05-038/1, BLACK					
PROJECT:		DRAWN BY: CJS DATE: 2/29/2008		APPROVED BY: DATE:	
				REV: A	

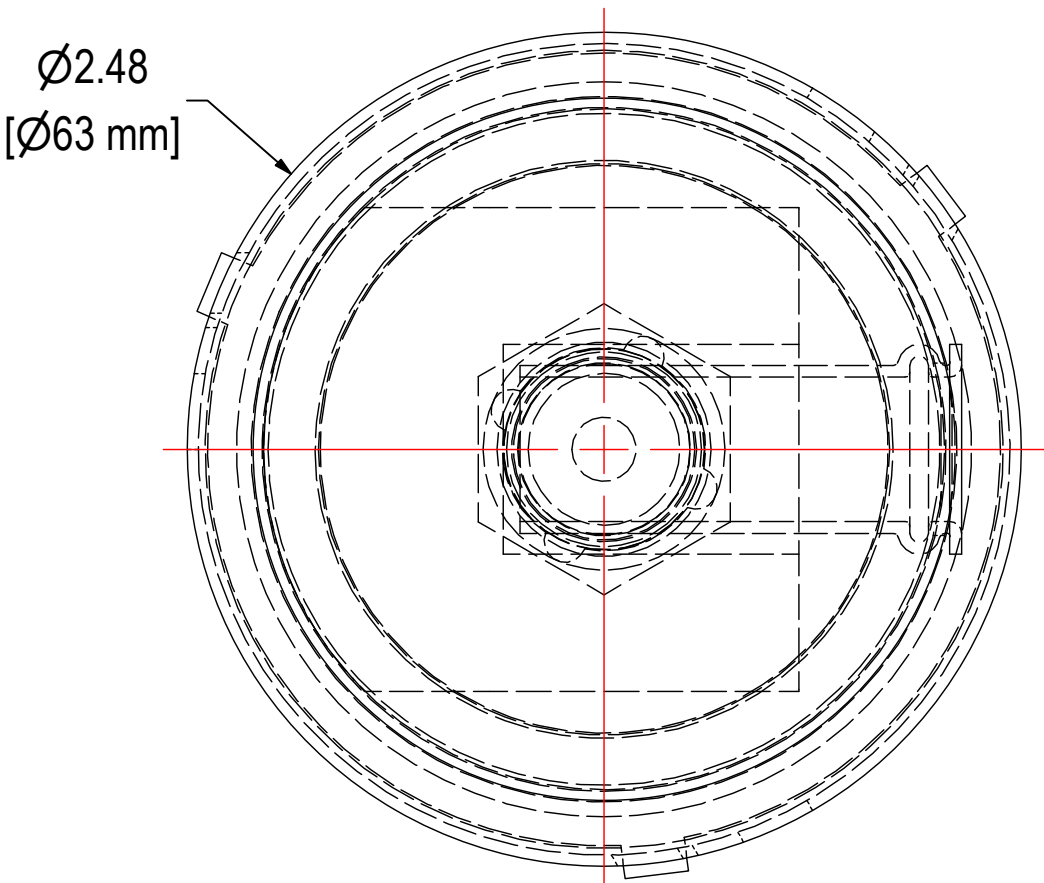

# SOLBERG®

**Filtration • Separation • Silencing**  
630.773.1363 • [www.solbergmfg.com](http://www.solbergmfg.com)

THE INFORMATION CONTAINED HEREIN IS CONFIDENTIAL AND THE PROPERTY OF SOLBERG MANUFACTURING INC. AND IT IS FURNISHED TO YOU WITH THE EXPRESS UNDERSTANDING THAT IT WILL NOT BE REPRODUCED, COPIED IN ANY MANNER, LOANED OR OTHERWISE TRANSFERRED TO OTHERS ENTIRELY OR IN PART, NOR USED FOR ANY PURPOSE OTHER THAN FOR WHICH IT WAS FURNISHED. IT WILL BE RETURNED UPON REQUEST TO SOLBERG MANUFACTURING INC. THE ABOVE RESTRICTION IS IN ADDITION TO, AND DOES NOT IN ANY WAY ALTER, ANY OTHER RESTRICTIONS WHICH MAY APPLY TO THE INFORMATION CONTAINED HEREIN.

**TOLERANCES**  
DIMENSIONS ARE FOR REFERENCE ONLY. ALL DIMENSIONS ARE SUBJECT TO CHANGE UPON PRODUCTION.  
**UNLESS OTHERWISE SPECIFIED:**  
-DIMENSIONS ARE IN INCHES  
-REF: APPROXIMATE DIMENSIONS, NO TOLERANCES APPLY  
-FINISH: BREAK EDGES TO .005-.020 RADIUS/CHAMFER