

REV	DESCRIPTION	ECN #	CHG BY	DATE	APP'D
A	UPDATED TB, ADDED METRIC DATA	-	JCB	07/09/12	-
B	CONVERTED TO 3D, 1" COUPLINGS WERE NPSC	8447	NAD	06/13/16	CRW
C	FINISH WAS BLUE EPOXY	DCR91	NAD	02/08/17	MJC

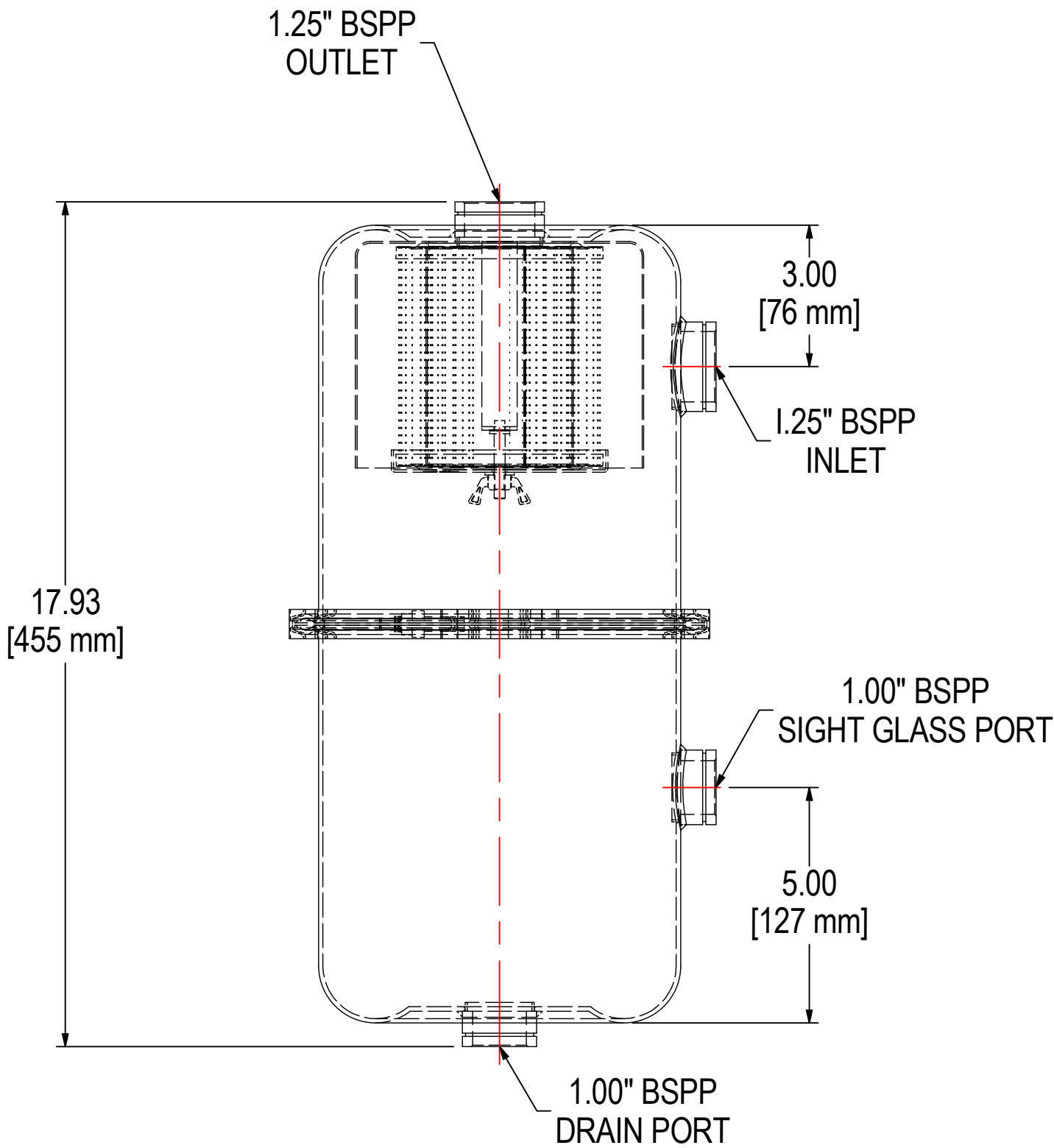
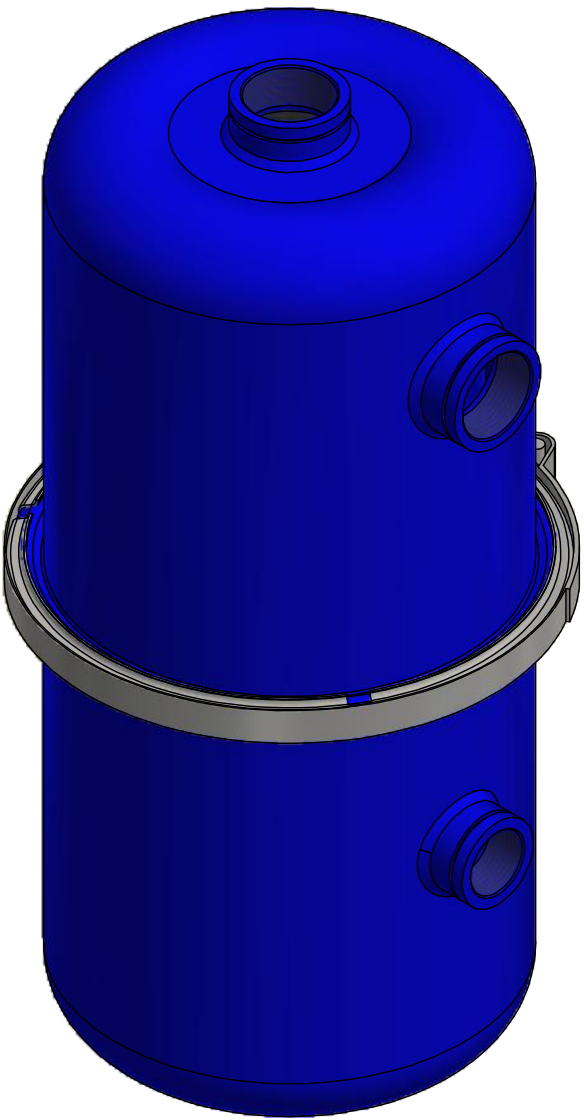
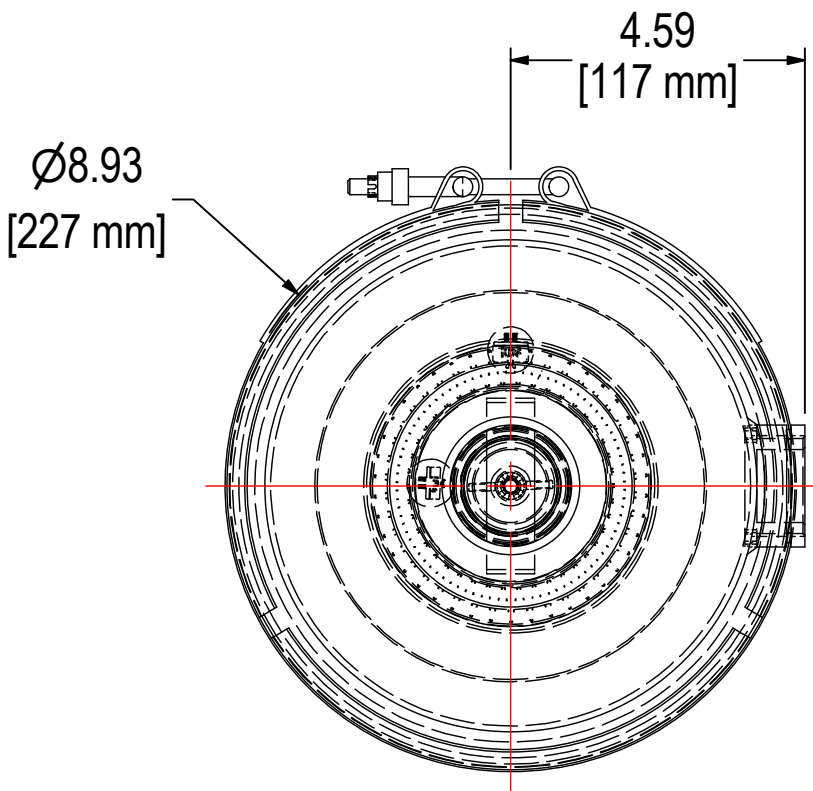

ELEMENT SPECS		
PART NUMBER	19	
MATERIAL	POLYESTER	
FLOW RATE	100 CFM	170 m³/hr
SURFACE AREA	1.4 ft²	0.1 m²
I.D.	3.00"	76mm
O.D.	4.40"	112mm
HEIGHT	4.81"	122mm

MODEL #: LRS-19-126HC		MATERIAL: CARBON STEEL		FINISH: BLUE POWDER		<div>C</div>	
MODEL NUMBER: LRS-19-126HC						SHEET: 1 OF 1	
DESCRIPTION: LRS-19-126HC, BLUE POWDER						<div>C</div>	
PROJECT: SD11392		DRAWN BY: CRW DATE: 3/31/2004		APPROVED BY: P.G. DATE: 4/5/2004		REV: C	