

REV	DESCRIPTION	ECN #	CHG BY	DATE	APP'D
A	ADDED VIEWS & LABEL	-	JCB	07/20/11	M.C.
B	CONVERTED TO 3D	10823	TAS	03/29/17	CCS
C	ADDED NOTE 1	18909	TAS	05/21/20	NAD

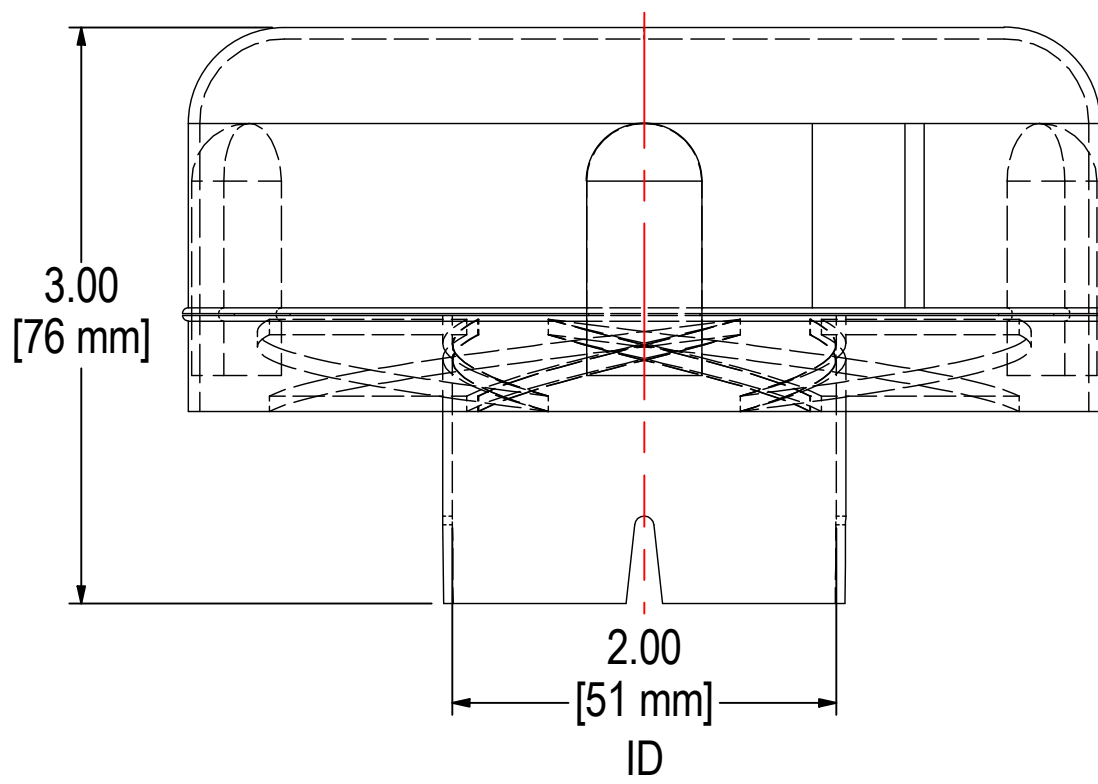

NOTES & SPECIFICATIONS:

1. FLOW RATING: 20 - 100 SCFM (34 - 170 m3/hr).

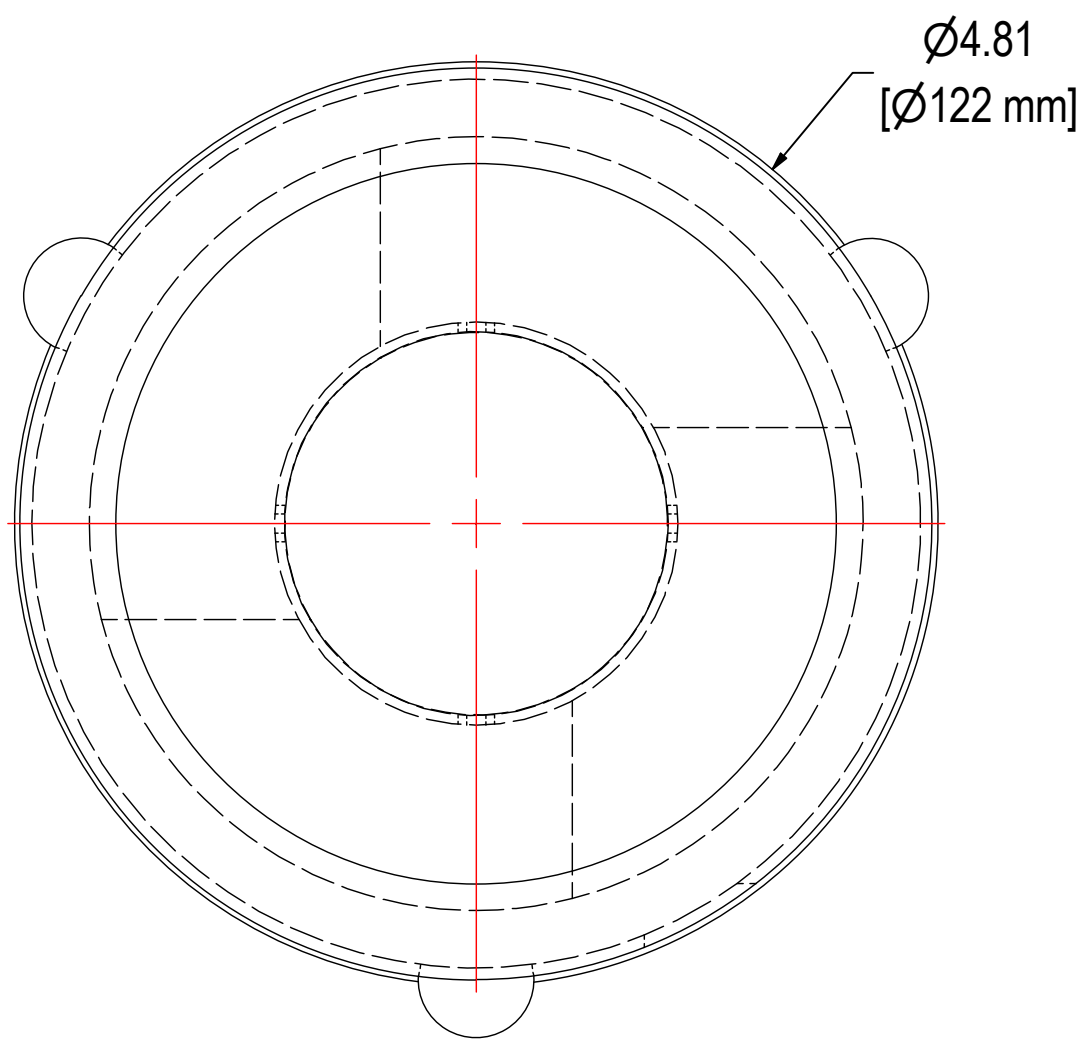

# SOLBERG®

**Filtration • Separation • Silencing**  
630.773.1363 • [www.solbergmfg.com](http://www.solbergmfg.com)

THE INFORMATION CONTAINED HEREIN IS CONFIDENTIAL AND THE PROPERTY OF SOLBERG MANUFACTURING INC. AND IT IS FURNISHED TO YOU WITH THE EXPRESS UNDERSTANDING THAT IT WILL NOT BE REPRODUCED, COPIED IN ANY MANNER, LOANED OR OTHERWISE TRANSFERRED TO OTHERS ENTIRELY OR IN PART, NOR USED FOR ANY PURPOSE OTHER THAN FOR WHICH IT WAS FURNISHED. IT WILL BE RETURNED UPON REQUEST TO SOLBERG MANUFACTURING INC. THE ABOVE RESTRICTION IS IN ADDITION TO, AND DOES NOT IN ANY WAY ALTER, ANY OTHER RESTRICTIONS WHICH MAY APPLY TO THE INFORMATION CONTAINED HEREIN.

**TOLERANCES**  
DIMENSIONS ARE FOR REFERENCE ONLY. ALL DIMENSIONS ARE SUBJECT TO CHANGE UPON PRODUCTION.  
**UNLESS OTHERWISE SPECIFIED:**  
-DIMENSIONS ARE IN INCHES  
-REF: APPROXIMATE DIMENSIONS, NO TOLERANCES APPLY  
-FINISH: BREAK EDGES TO .005-.020 RADIUS/CHAMFER

MODEL #: SM2		MATERIAL: PLASTIC		FINISH: NONE	
MODEL NUMBER: SM2					SHEET: 1 OF 1
DESCRIPTION: 2" SPINMEISTER					
PROJECT: SD11882		DRAWN BY: CRW DATE: 5/9/2005		APPROVED BY: DATE:	
				REV: C	